

South Carolina

(216)

Pursuant to a warrant from Mr. Thomas, Commissioner of Locations of S. Carolina dated the 16th day of October 1797 I have laid out unto Edward Pugh a tract of one hundred & twenty three acres of land situate in Laurens County lying on the branches of Space river, running with Edward Pugh's land S. E. & S. W. 1/4th with Tom Howler's Holloway Pours land, and hath such shape & marks as the above plat represents - Survey'd 16th day of October 1797 Recorded the 27th Novm. 1797 J. James Wofford D.

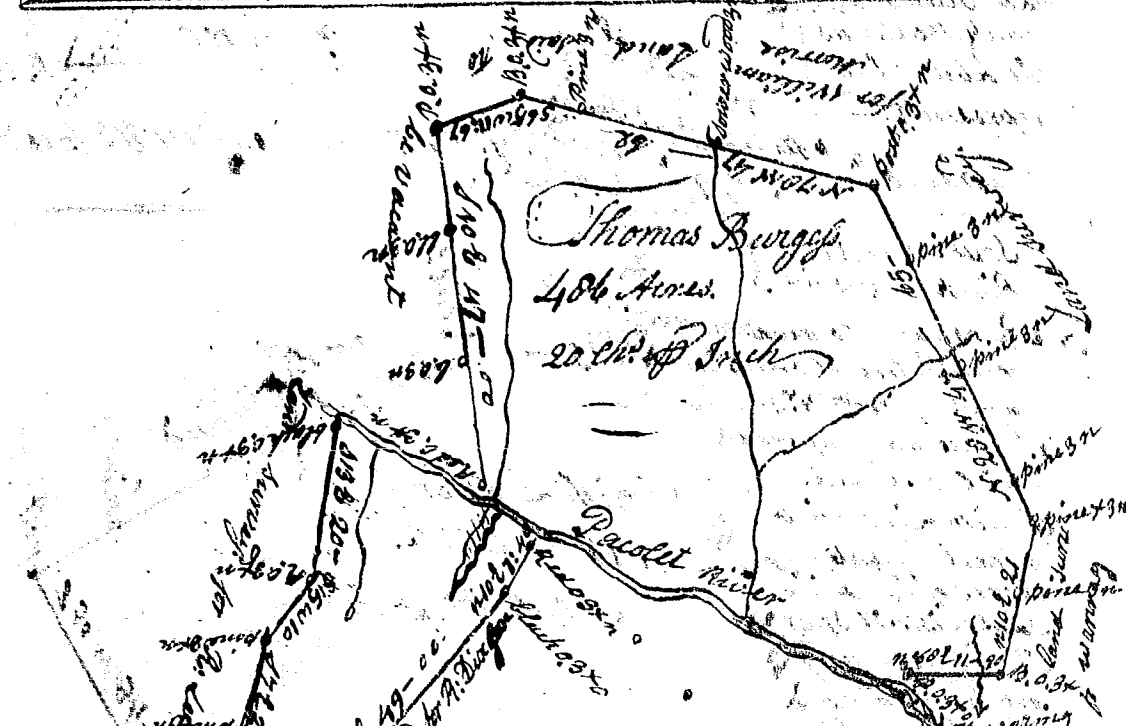
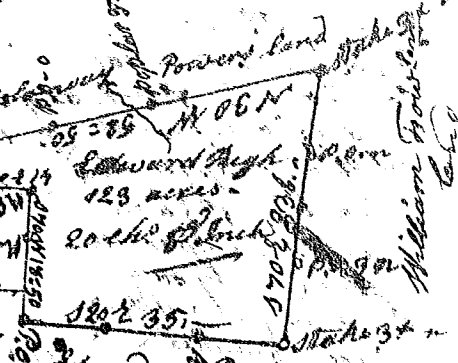

South Carolina Pursuant to a warrant from John Thomas, Comr of Locations dated 8th Oct^r 1797, I have admeasured and laid out unto Thomas Burges a tract of four hundred & eighty six acres of land in Pinkney District and Spartanburg County on Pacolat River, bounded by lines running N.E. by Hughly Thomas Warring N.W. by land of William Morris S.W. & S.E. said to be Vacant Land S.E. & S.W. by Richard Lee N.E. by Martin Dixon, and hath such form and marks as the above plat represents. Survey'd 26th Nov^r 1797 - Recorded 20th Nov^r 1797, J. Benson

J. Benson D.